

# 210-001 Instrucciones de instalación

Dimensiones de instalación para tableros de 16mm

● Máxima carga: 30 KG

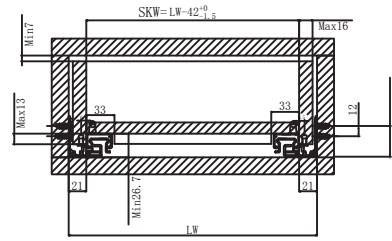

LW= Anchura interior del módulo SKW=Ancho del cajón Max Min

Dimensiones del cajón  
SKL - Longitud del cajón  
LT - Longitud interior del módulo

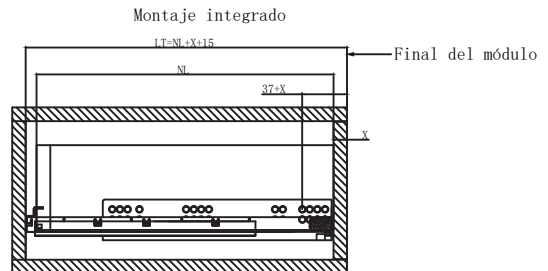
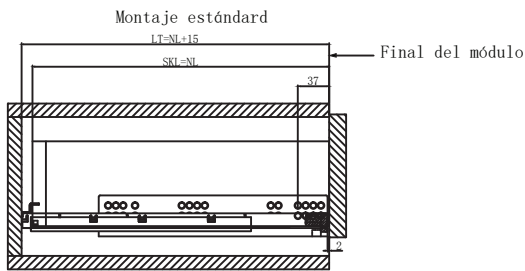

NL= Longitud Nominal de la guía LT= Profundidad interior del módulo SKL= Longitud del cajón X= Espesor del frontal

Dimensiones de la base del cajón

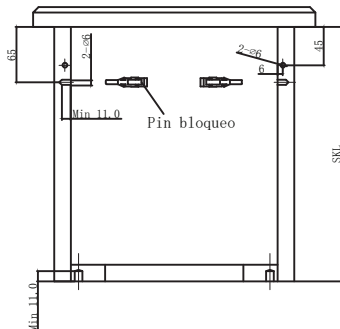
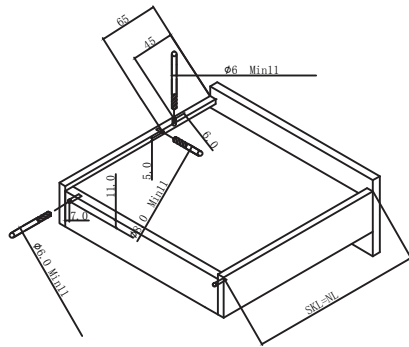

Dimensiones de instalación

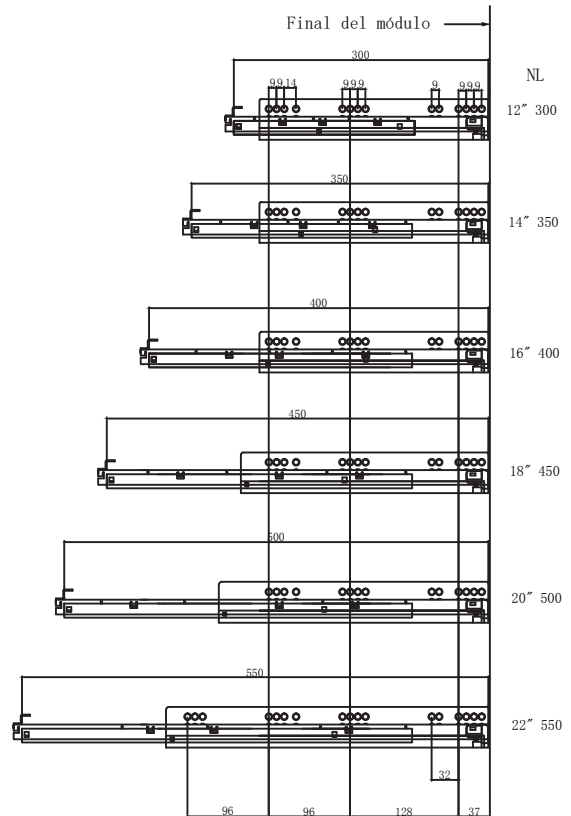

## INFORME DEL TEST

N ° : GZIN1602006399ML

Fecha: 07 de Marzo de 2016

Pág. : 1 de 3

NOMBRE DEL CLIENTE: DISTRIBUIDORA VALENCIANA DE FERRETERIA SL  
DIRECCION: PARED DECANTA 26, 46900 TORRENT - VALENCIA

La siguiente muestra fué aportada e identificada por el cliente como:

Descripción de la muestra : Guía cuadro Soft Closing 350mm.  
Referencia del Cliente : 210 001 35  
Fabricante : DISTRIBUIDORA VALENCIANA DE FERRETERIA, S.L.  
Fecha de recepción de la muestra : 24 de Febrero de 2016  
Fecha del test : 24 de Febrero de 2016 al 07 de Marzo de 2016  
Resultado del Test : Para más detalles dirijase a las siguientes páginas.

Firmado por  
SGS-CSTC Standards Technical  
Services Co., Ltd. Laboratorio de Análisis

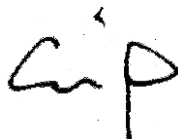

Shining Chan  
Firma autorizada



This document is issued by the Company subject to its General Conditions of Service printed overleaf, available on request or accessible at <http://www.sgs.com/en/Terms-and-Conditions.aspx> and, for electronic format documents, subject to Terms and Conditions for Electronic Documents at <http://www.sgs.com/en/Terms-and-Conditions/Terms-e-Documents.aspx>. Attention is drawn to the limitation of liability, indemnification and jurisdiction issues defined therein. Any holder of this document is advised that information contained hereon reflects the Company's findings at the time of its intervention only and within the limits of Client's instructions, if any. The Company's sole responsibility is to its Client and this document does not exonerate parties to a transaction from exercising all their rights and obligations under the transaction documents. This document cannot be reproduced except in full, without prior written approval of the Company. Any unauthorized alteration, forgery or falsification of the content or appearance of this document is unlawful and offenders may be prosecuted to the fullest extent of the law. Unless otherwise stated the results shown in this test report refer only to the sample(s) tested and such sample(s) are retained for 30 days only.

Attention: To check the authenticity of testing /inspection report & certificate, please contact us at telephone: (86-755) 8307 1443, or email: [CN.Doccheck@sgs.com](mailto:CN.Doccheck@sgs.com)

SGS-CSTC Standards Technical Services Co., Ltd.  
Guangzhou Economic & Technology Development District Laboratory

198 Kezhu Road, Science Park Guangzhou Economic & Technology Development District, Guangzhou, China 510663 t (86-20) 82155661 f (86-20) 82075080 www.sgsgroup.com.cn  
中国·广州·经济技术开发区科学城科珠路198号 邮编: 510663 t (86-20) 82155661 f (86-20) 82075080 e [sgs.china@sgs.com](mailto:sgs.china@sgs.com)

# TEST REPORT

N ° : GZIN1602006399ML

Fecha: 07 de Marzo de 2016

Pág. : 2 de 3

## Resultado del Test

Test(s) Requerido	Resultado(s)
Test de durabilidad de la Guía	: APTO

## TESTS Y RESULTADOS

### Test Llevado a cabo:

Test de durabilidad de la Guía según las instrucciones del cliente.

### Condiciones Generales del Test:

El siguiente test ha sido llevado a cabo en un ambiente mantenido de laboratorio entre 15°C y 25°C, con una H.R. del 50%±5. La muestra fue testada individualmente, después de estar acondicionada en el lugar del test al menos 24h antes de empezar la prueba.

El procecimiento detallado completo, puede ser encontrado en el apartado correspondiente.

Si no se especifica lo contrario, el test será llevado a cabo en el siguiente order con la misma muestra.

### Número de muestras:

1 Par (Muestra 1). Para más información sobre la muestra, diríjase a las páginas siguientes:

Test	Descripción del Test	Resultado(s)
Test de Durabilidad de la guía	<p>a. Montar la guía en el cajón de ensayo.</p> <p>b. Colocar peso en la guía. Incluyendo el peso de la guía, el peso total debe ser de 30kg tal y como especifica el cliente.</p> <p>c. Conectar el frontal del cajón a una máquina de ciclos, la cual puede abrir y cerrar el cajón por sí misma.</p> <p>d. Un ciclo consiste en la apertura total, y cierre completo del cajón.</p> <p>e. El número de ciclos es de 50,000 y su frecuencia, 10 ciclos por minuto.</p> <p>Criterios: No se debe observar ningún daño ni fallo en el correcto funciona - miento del producto durante el test.</p>	APTO

### Notas:

1. La carga total de 30kg y el número de ciclos, 50000 fueron especificados por el cliente.
2. Las dimensiones del cajón del test eran 560mm(Ancho), 360mm(Fondo) por 120mm(Altura).
3. Para información de la muestra e imágenes, diríjase a la siguiente página.



This document is issued by the Company subject to its General Conditions of Service printed overleaf, available on request or accessible at <http://www.sgs.com/en/Terms-and-Conditions.aspx> and, for electronic format documents, subject to Terms and Conditions for Electronic Documents at <http://www.sgs.com/en/Terms-and-Conditions/Terms-e-Documents.aspx>. Attention is drawn to the limitation of liability, indemnification and jurisdiction issues defined therein. Any holder of this document is advised that information contained hereon reflects the Company's findings at the time of its intervention only and within the limits of Client's instructions, if any. The Company's sole responsibility is to its Client and this document does not exonerate parties to a transaction from exercising all their rights and obligations under the transaction documents. This document cannot be reproduced except in full, without prior written approval of the Company. Any unauthorized alteration, forgery or falsification of the content or appearance of this document is unlawful and offenders may be prosecuted to the fullest extent of the law. Unless otherwise stated the results shown in this test report refer only to the sample(s) tested and such sample(s) are retained for 30 days only.

Attention: To check the authenticity of testing /inspection report & certificate, please contact us at telephone: (86-755) 8307 1443, or email: [CN.Doccheck@sgs.com](mailto:CN.Doccheck@sgs.com)

SGS-CALIBRATED LABORATORY  
Guangzhou Economic & Technology Development District

198 Kezhu Road, Science Park Guangzhou Economic & Technology Development District, Guangzhou, China 510663 t (86-20) 82155661 f (86-20) 82075080 www.sgsgroup.com.cn  
中国·广州·经济技术开发区科学城科珠路198号 邮编: 510663 t (86-20) 82155661 f (86-20) 82075080 e [sgs.china@sgs.com](mailto:sgs.china@sgs.com)

## TEST REPORT

N ° : GZIN1602006399ML

Fecha: 07 de Marzo de 2016

Pág. : 3 de 3

### INFORMACION DE LA MUESTRA E IMAGENES

**Peso:** 762 g

**Dimensions:** 360 mm de longitud

**Other Dimensions:** /

#### Muestra Recibida



Muestra antes del test - Vista 1



Muestra antes del test - Vista 2



Muestra para el Test - Vista 3



Muestra después del test - Vista 4

\*\*\*\*\* Fin del Test\*\*\*\*\*



This document is issued by the Company subject to its General Conditions of Service printed overleaf, available on request or accessible at <http://www.sgs.com/en/Terms-and-Conditions.aspx> and, for electronic format documents, subject to Terms and Conditions for Electronic Documents at <http://www.sgs.com/en/Terms-and-Conditions/Terms-e-Documents.aspx>. Attention is drawn to the limitation of liability, indemnification and jurisdiction issues defined therein. Any holder of this document is advised that information contained hereon reflects the Company's findings at the time of its intervention only and within the limits of Client's instructions, if any. The Company's sole responsibility is to its Client and this document does not exonerate parties to a transaction from exercising all their rights and obligations under the transaction documents. This document cannot be reproduced except in full, without prior written approval of the Company. Any unauthorized alteration, forgery or falsification of the content or appearance of this document is unlawful and offenders may be prosecuted to the fullest extent of the law. Unless otherwise stated the results shown in this test report refer only to the sample(s) tested and such sample(s) are retained for 30 days only.

Attention: To check the authenticity of testing /inspection report & certificate, please contact us at telephone: (86-755) 8307 1443, or email: [CN.Doccheck@sgs.com](mailto:CN.Doccheck@sgs.com)

SGS-CTI Standards Technical Services Co., Ltd.  
Guangzhou Branch

198 Kezhu Road, Science Park Guangzhou Economic & Technology Development District, Guangzhou, China 510663 t (86-20) 82155661 f (86-20) 82075080 www.sgs.com.cn  
中国·广州·经济技术开发区科学城科珠路198号 邮编: 510663 t (86-20) 82155661 f (86-20) 82075080 e [sgs.china@sgs.com](mailto:sgs.china@sgs.com)